

SOTTOPASSO 1 - VIA MONTALE

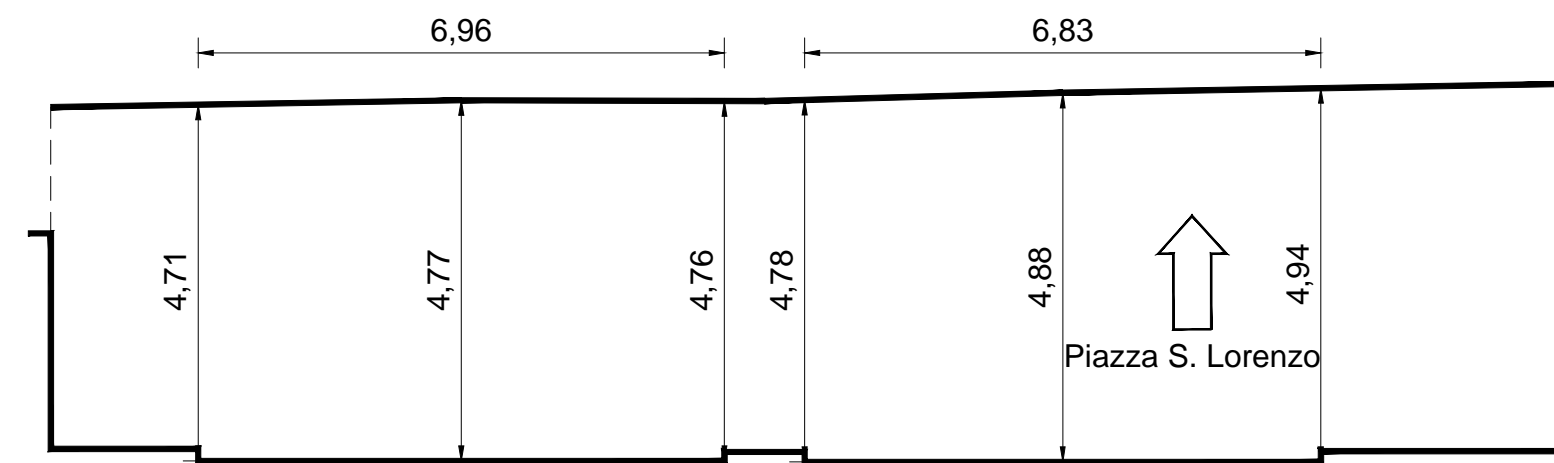

SOTTOPASSO 2 - VIALE MILANO

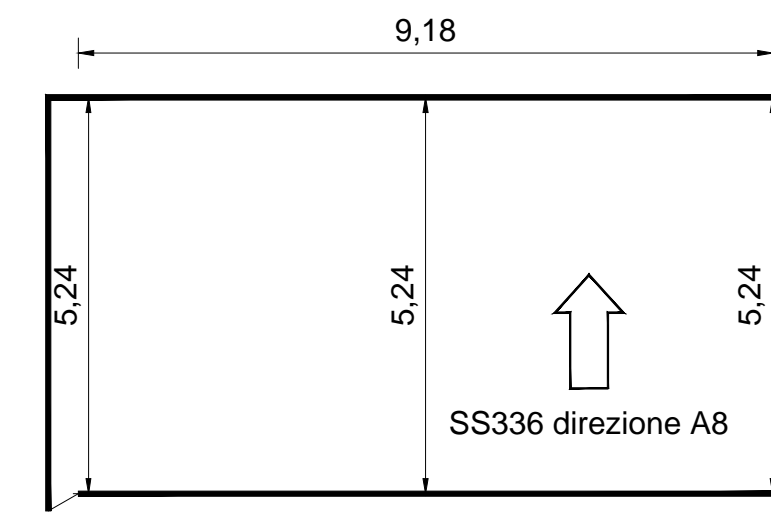

SOTTOPASSO 3 - VIA C. NOÈ

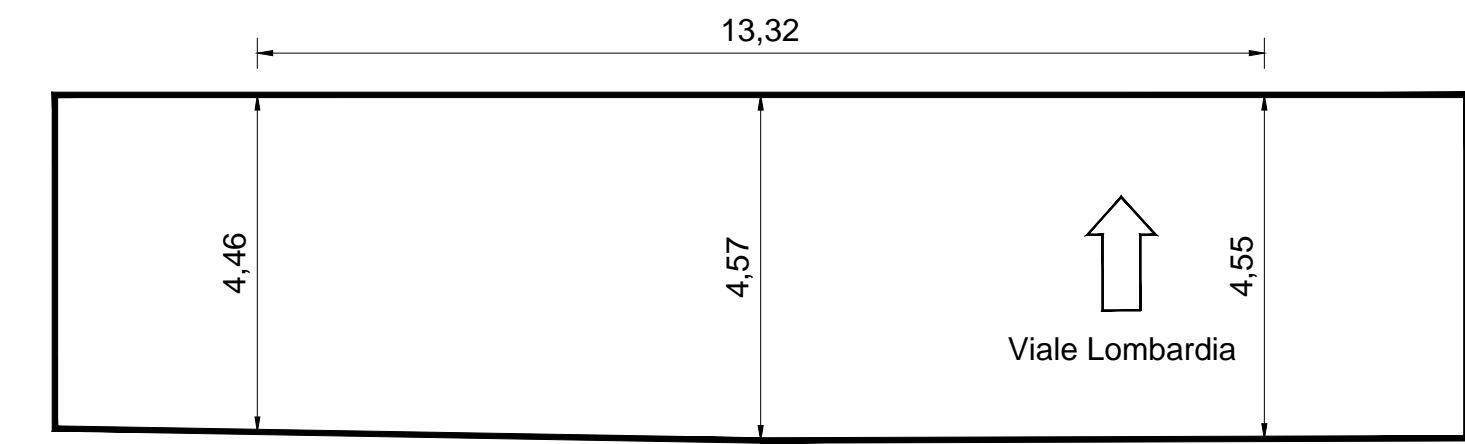

SOTTOPASSO 4 - VIA PRADERIO

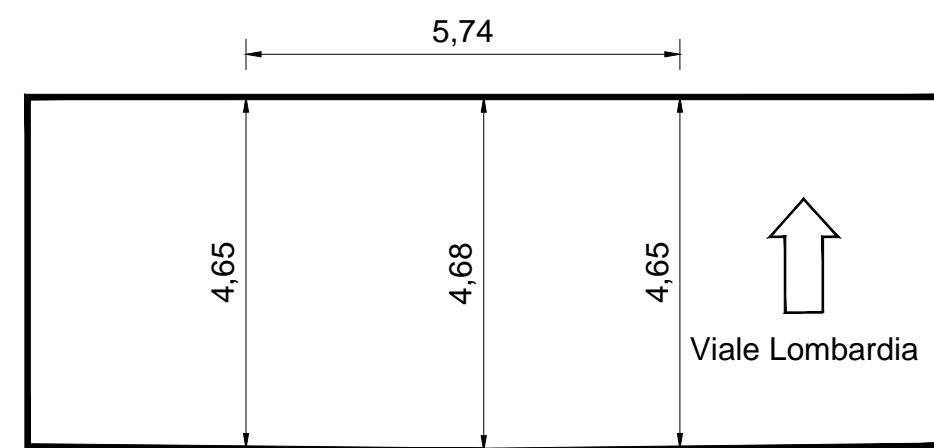

SOTTOPASSO 5 - VIA CANOVA

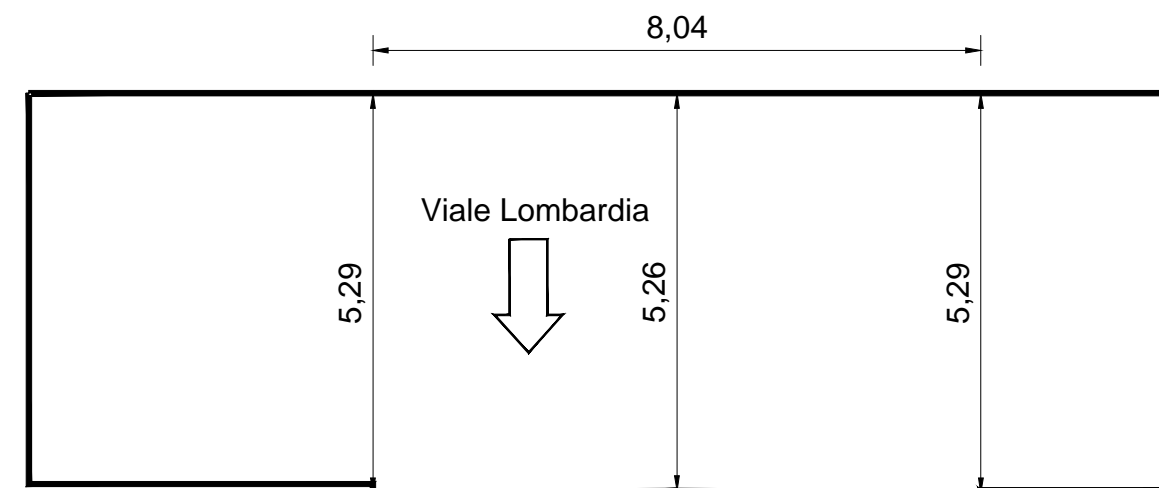

SOTTOPASSO 6 - VIA ARCONTI

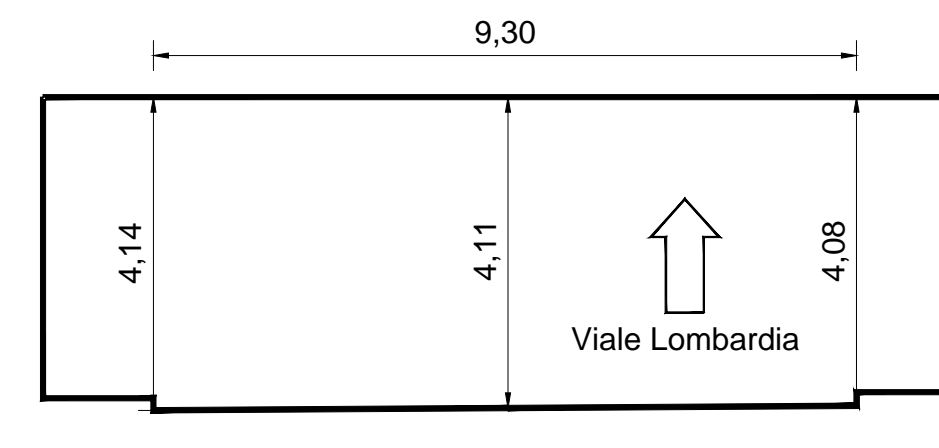

SOTTOPASSO 7 - VIA MAMELI

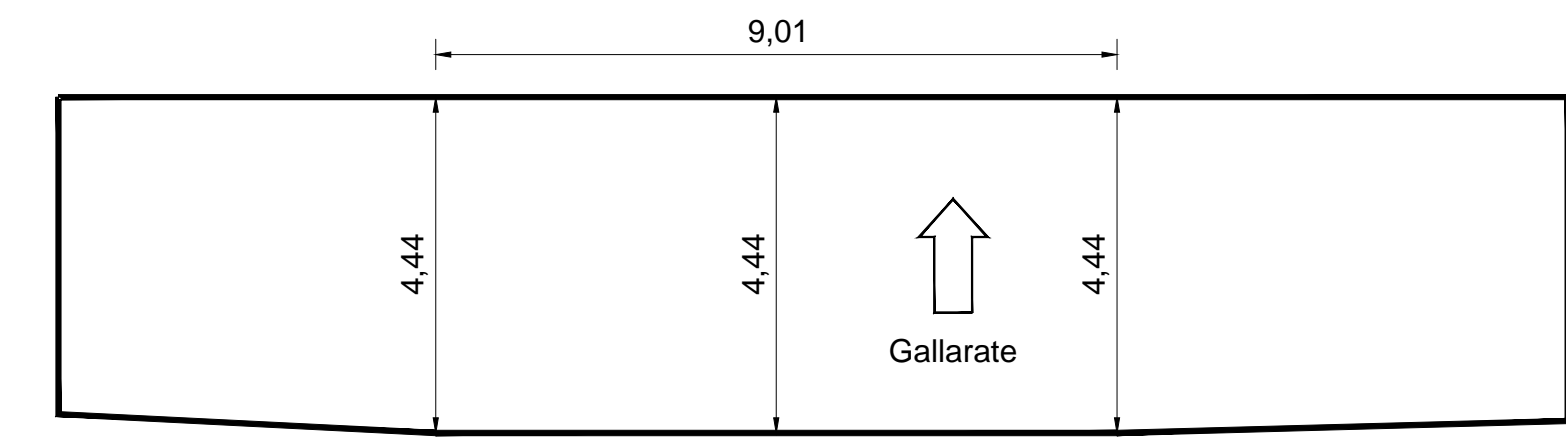

SOTTOPASSO 8 - VIA VITTORIO VENETO

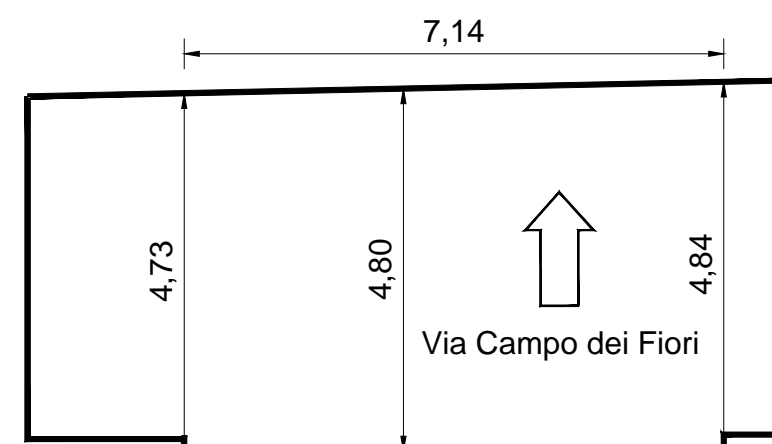

SOTTOPASSO 9 - VIA CAMPO DEI FIORI

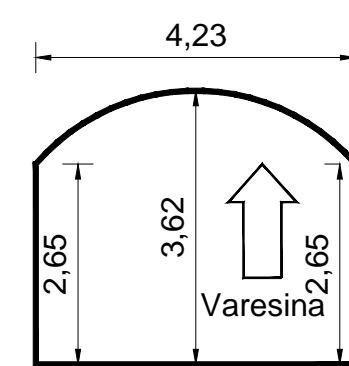

SOTTOPASSO 10 - VIA LIBERAZIONE

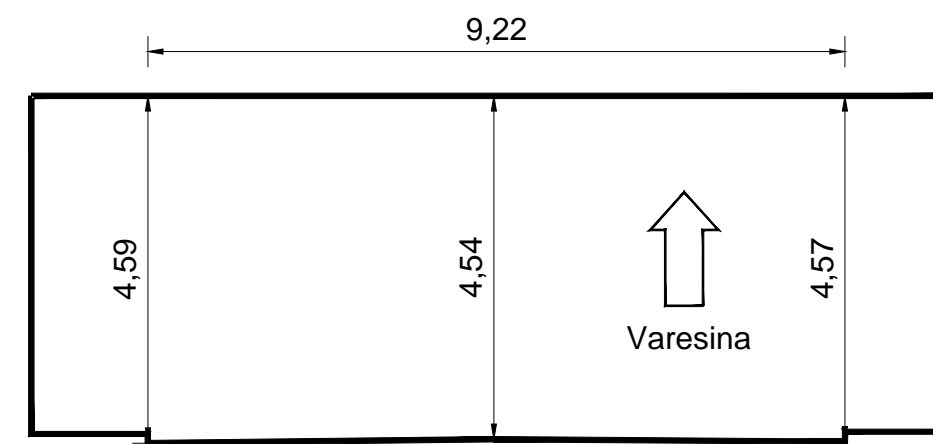

SOTTOPASSO 11 - VIA DEL LAVORO

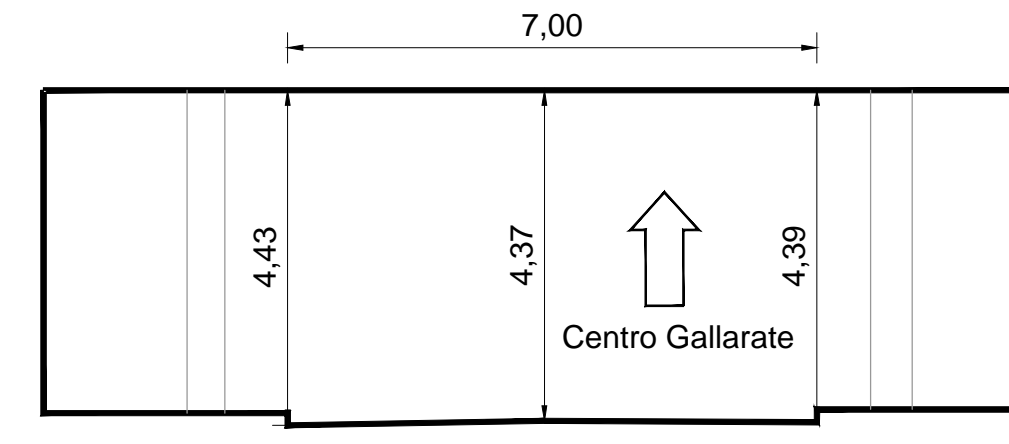

SOTTOPASSO 12 - VIA RONCHETTI

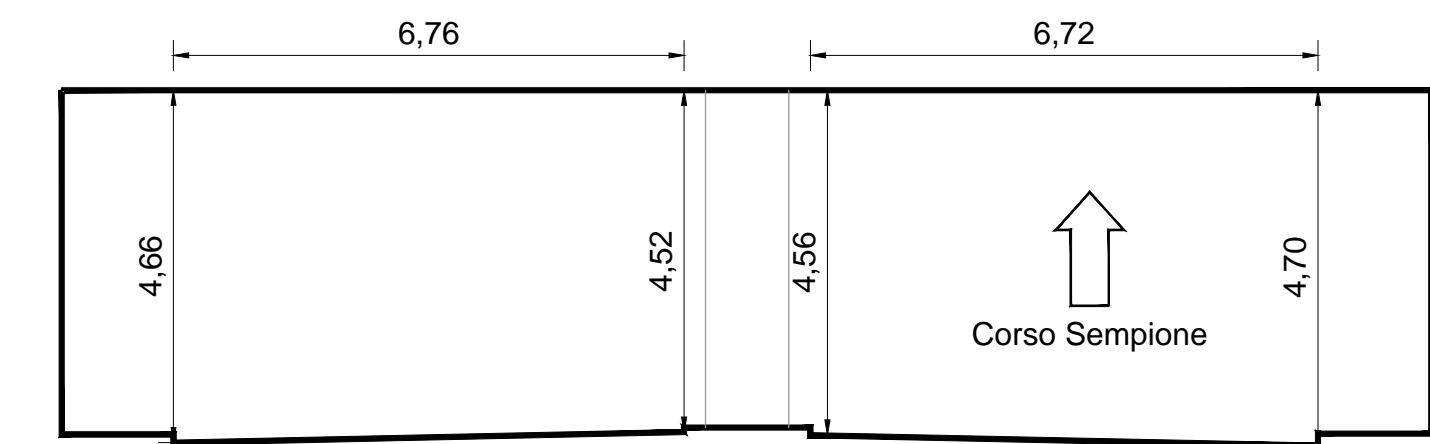

SOTTOPASSO 13 - VIA BOLIVIA

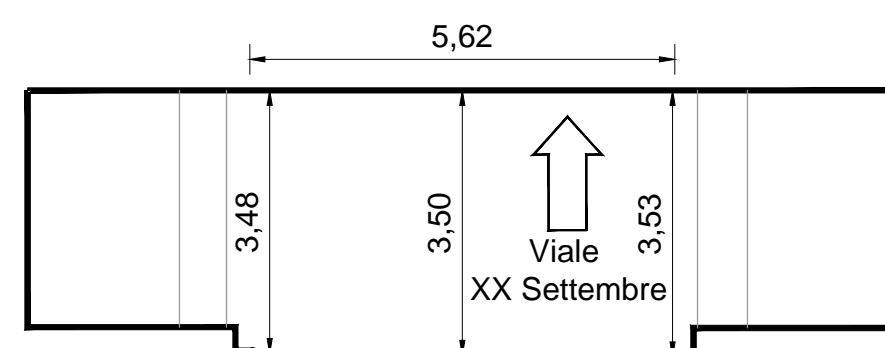

SOTTOPASSO 14 - VIA VENEGONI

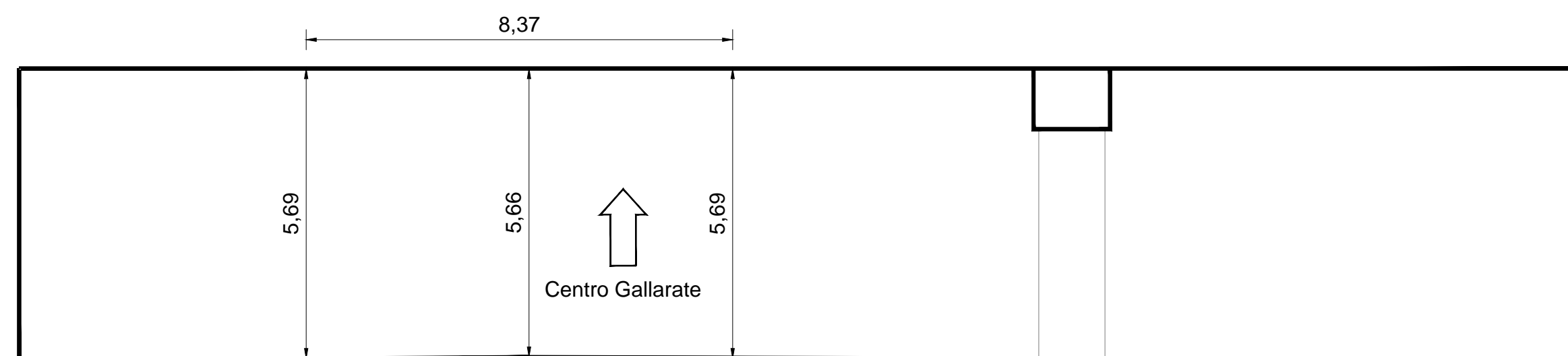

SOTTOPASSO 15 - CORSO SEMPIONE

SCALA 1:100

SOTTOPASSI					
Cod.	UBICAZIONE	PROPRIETA'	TIPO LUCE	LARGHEZZA	ALTEZZA MINIMA
1	Via Montale	Società Autostrade	Rettangolare	13,73 m	4,46 m
2	Viale Milano	Comune di Gallarate	Rettangolare	6,96 m + 6,83 m	4,71 m
3	Via C. Noè	ANAS S.p.A.	Rettangolare	9,18 m	5,24 m
4	Via Praderio	Società Autostrade	Rettangolare	13,32 m	4,46 m
5	Via Canova	Società Autostrade	Rettangolare	5,74 m	4,65 m
6	Via Arconti	Società Autostrade	Rettangolare	8,04 m	5,26 m
7	Via Mameli	Società Autostrade	Rettangolare	9,30 m	4,08 m
8	Via Vittorio Veneto	Società Autostrade	Rettangolare	9,01 m	4,44 m
9	Via Campo dei Fiori	Società Autostrade	Rettangolare	7,14 m	4,73 m
10	Via Liberazione	RFI	Arcuata	4,23 m	2,65 m
11	Via del Lavoro	RFI	Rettangolare	9,22 m	4,54 m
12	Via Ronchetti	RFI	Rettangolare	7,00 m	4,37 m
13	Via Bolivia	Comune di Gallarate	Rettangolare	6,76 m + 6,72 m	4,52 m
14	Via Venegoni	RFI	Rettangolare	5,62 m	3,48 m
15	Corso Sempione	Comune di Gallarate	Rettangolare	8,37 m	5,66 m